

G-11 SERIES

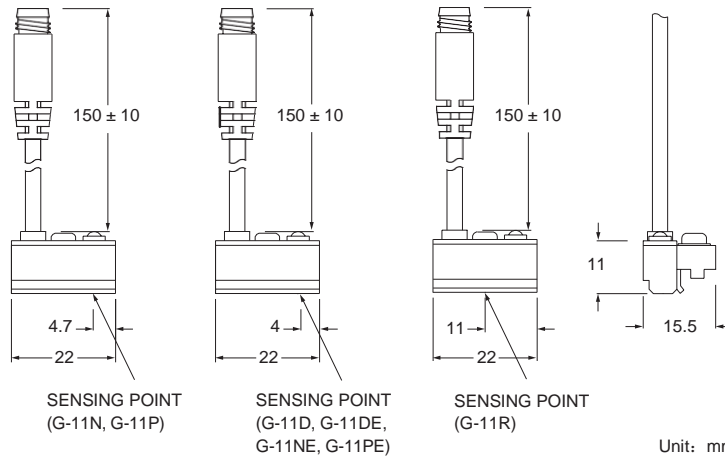

Dimensions

G-11R, G-11D, G-11DE, G-11N, G-11NE, G-11P, G-11PE / G-11R-QD, G-11D-QD, G-11DE-QD, G-11N-QD, G-11NE-QD, G-11P-QD, G-11PE-QD



Unit: mm

QD Pinout

3 wire QD wiring

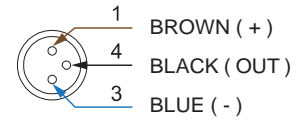

2 wire QD wiring

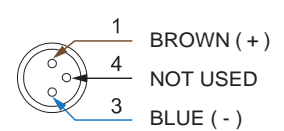

2 wire EQD wiring

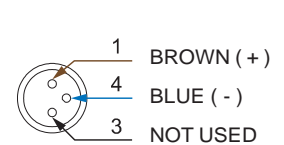

Specifications

| MODEL | G-11R | G-11D | G-11DE | G-11N | G-11NE | G-11P | G-11PE |
|---------------------------------|--|----------------|---------------------|--|--------------------|----------------------|--------------------|
| Connect Diagram | | | | | | | |
| Characteristics | 2-Wire type | | | 3-Wire type | | | |
| Wiring Method | 2-Wire type | | | 3-Wire type | | | |
| Switching Logic | SPST, Normally Open | - | | Solid State Output, Normally Open | | | |
| Sensor Type | Reed Switch | - | | NPN Current Sinking | | PNP Current Sourcing | |
| Operating Voltage | 5 ~ 240 V DC / AC | 10 ~ 28 V DC | | 5 ~ 30 V DC | | | |
| Switching Current | 100 mA max. | 4 ~ 40 mA max. | 50 mA max. | 200 mA max. | | | |
| Contact Rating ※1 | 10 W max. | 1.1 W max. | 1.5 W max. | 6 W max. | | | |
| Current Consumption | - | | | 22 mA @ 24 VDC max. | 6 mA @ 24 VDC max. | 20 mA @ 24 VDC max. | 6 mA @ 24 VDC max. |
| Voltage Drop | 3.5 V max. | | 3.7 V max. | 0.5 V @ 200 mA max. | | | |
| Leakage Current | - | 1 mA max. | 0.1 mA (40 uA) max. | 0.01 mA max. | | | |
| Indicator | Red LED | Green LED | | Red LED | | Green LED | |
| Cable | Ø3.3 PVC - 24 AWG (0.22 mm ²) - 2 cores | | | Ø3.3 PVC - 24 AWG (0.22 mm ²) - 3 cores | | | |
| Operating Frequency | 200 Hz | 1000 Hz max. | | | | | |
| Magnet Requirement ※2 | 70 Gauss | 60 Gauss | 40 ~ 1000 Gauss | 60 Gauss | 40 ~ 1000 Gauss | 60 Gauss | 40 ~ 1000 Gauss |
| Temperature Range | -10 ~ 70 °C | | | | | | |
| Shock ※3 | 30 G | 50 G | | | | | |
| Vibration ※4 | 9 G | | | | | | |
| Enclosure Classification | IEC 60529 IP67 | | | | | | |
| Protection Circuit ※5 | 1 | 4 | | 3, 4 | | | |

NOTE

※1 : WARNING : Never exceed rating (Watt = Voltage x Amperage). Permanent damage to sensor will occur.

※2 : Measuring standard target : Ø15.5 × Ø8 × 5t (Anisotropy rubber magnet)

※3 : Sin wave / X , Y , Z 3 directions / 3 times each direction / 11 ms each time.

※4 : Double amplitude 1.5 mm / 10 Hz ~ 55 Hz ~ 10 Hz (Sweep 1 min) / X , Y , Z 3 directions / 1 hour each time.

※5 : 1 = None / 2 = Short-circuit / 3 = Power Source Reverse polarity / 4 = Surge Suppression

Groove Dimensions

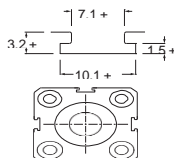

Unit: mm

GENTLE AUTOMATIC SOLUTION SDN BHD

No.36, Jalan Industri USJ 1/13, Taman Perindustrian USJ 1, 47600 Subang Jaya, Selangor.

TEL: 603 - 8023 7743 / 8743

FAX: 603 - 8023 9743

Email : sales@gentle.com.my