

G-65-UL SERIES



Patented

Dimensions

M8 Connector option is not available

G-65N-UL, G-65P-UL, G-65D-UL

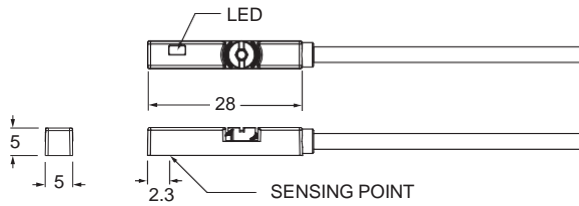

G-65R-UL, G-65RP-UL

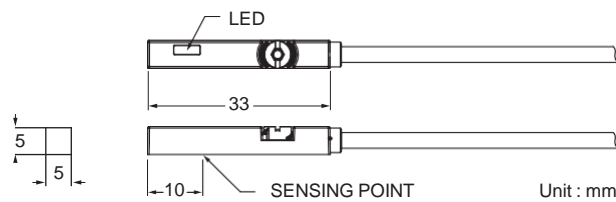

Unit : mm

Specifications

MODEL	G-65R-UL	G-65D-UL	G-65N-UL	G-65P-UL	G-65RP-UL
Connect Diagram					
Characteristics	2-Wire Type		3-Wire Type		
Wiring Method	2-Wire Type		3-Wire Type		
Switching Logic	SPST, Normally Open		Solid State Output, Normally Open		SPST, Normally Open
Sensor Type	Reed Switch	-	NPN Current Sinking	PNP Current Sourcing	Reed Switch
Operating Voltage	5 ~ 30 V DC / AC		10 ~ 28 V DC		10 ~ 30 V DC / AC
Switching Current	60 mA max.	40 mA max.	100 mA max.		
Contact Rating *1	1.8 W max.	1.2 W max.	3 W max.		
Current Consumption *2	-		10 mA @ 24 V DC max.		
Voltage Drop *2	3.0 V max.	3.5 V max.	1.5 V max.		0.1 V @ 100 mA max.
Leakage Current *2	-	0.8 mA max.	0.05 mA max.		-
Indicator	Red LED		Yellow LED		
Lead Wire	Ø2.8 PUR - 26 AWG (0.15 mm ²) - 2 cores		Ø2.8 PUR - 26 AWG (0.15 mm ²) - 3 cores		
Operating Frequency	200 Hz		1000 Hz		200 Hz
Magnet Requirement *2, *3	75 Gauss		50 Gauss		65 Gauss
Temperature Range	-10 ~ 60 °C		-10 ~ 70 °C		
Shock *4	30 G		50 G		30 G
Vibration *5			9 G		
Enclosure	IEC 60529 IP67				
Protection Circuit *6	1	2	2, 3, 4		1

NOTE

- *1 : WARNING : Never exceed rating (Watt = Voltage × Amperage). Permanent damage to sensor will occur.
- *2 : It bases on conditions of voltage 24 V DC, ambient temp. 25 °C and 2 meters cable of sensor. Voltage drop increases in pace with cable length.
- *3 : Measuring standard target : Ø15.5 × Ø8 × 5t (Anisotropy rubber magnet)

- *4 : Sin wave / X, Y, Z 3 directions / 3 times each direction / 11 ms each time.
- *5 : Double amplitude 1.5 mm / 10 Hz ~ 55 Hz ~ 10 Hz (Sweep 1 min) / X, Y, Z 3 directions / 1 hour each time.
- *6 : 1 = None / 2 = Short-circuit / 3 = Power Source Reverse polarity / 4 = Surge Suppression

Groove Dimensions | Clamp / Bracket

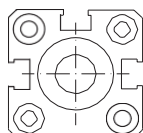
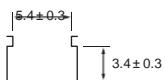

Unit : mm

Gentle Automatic Solution Sdn Bhd

No.36, Jalan Industri USJ 1/13, Taman Perindustrian USJ 1, 47600 Subang Jaya, Selangor.
TEL: 603-8023 7743 / 8743 FAX: 603-8023 9743

sales@gentle.com.my
www.gentle.com.my

0122738827
waze.to/lr/hw28325k63